



Yamaha PSX2YE 2026

Parts Manual

www.floodmarine.co.uk

+44 2882 246 539

Authorised Yamaha Dealers



Contents

POWER UNIT	3
STEERING HANDLE & CABLE	5

Power Unit

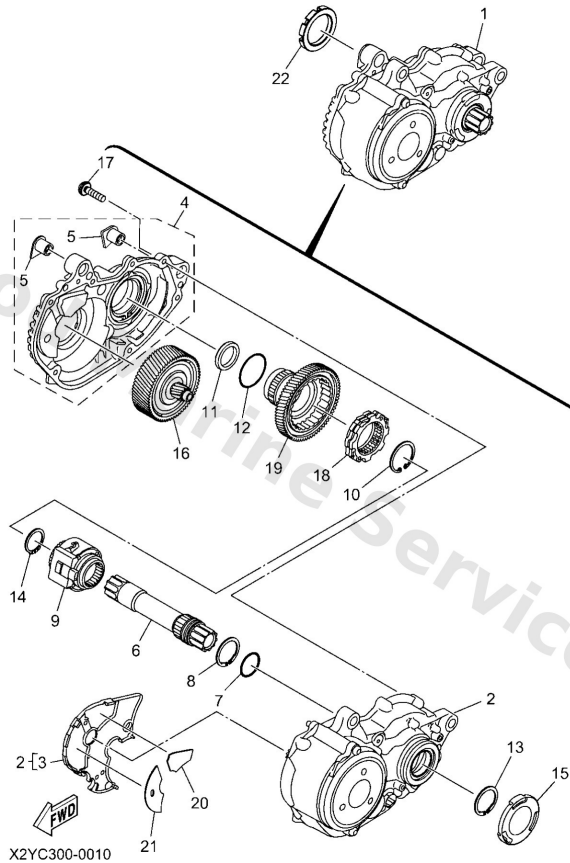

Ref	Part	
1	X2Y17061E0 - PW-X3, '26	Buy now
2	X2Y81804E0 -	Buy now
3	X2Y1752400 Holder	Buy now
4	X2Y1751000 Housing comp.	Buy now
5	X2Y1518900 Plug	Buy now
6	X2Y1741100 Axle, main	Buy now
7	9321022010 O-ring	Buy now
8	9900924800 Circlip	Buy now
9	X2Y1706200 Torque sensor assembly	Buy now
10	9900930500 Circlip (650)	Buy now
11	X0P1634700 Seal, dust	Buy now
12	9321032006 O-ring	Buy now
14	9341022098 Circlip	Buy now
15	X2Y1815400 Cover, dust	Buy now
16	X2Y1784020 -	Buy now

Power Unit

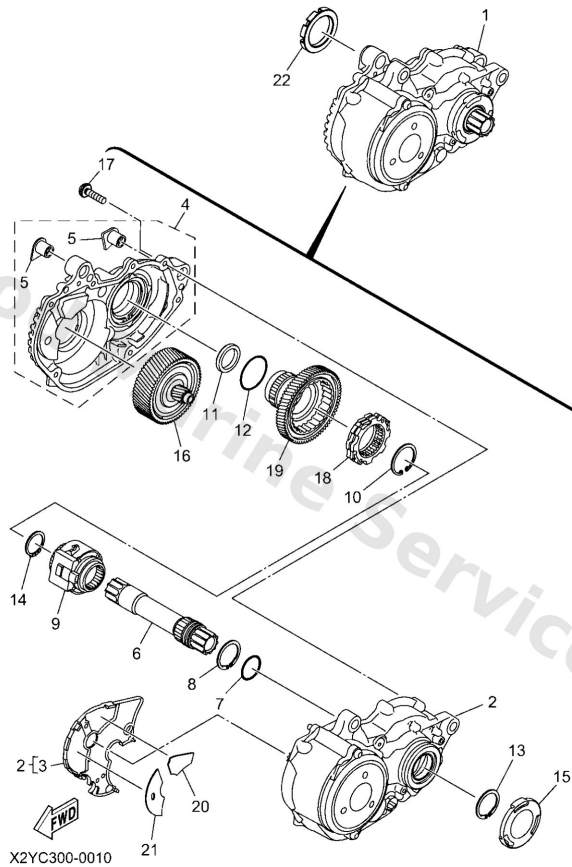

Ref	Part	
17	9014904006 Screw	Buy now
18	X2Y1676000 One-way clutch comp.	Buy now
19	X2Y1661100 Clutch housing comp.	Buy now
20	X2Y8A8B010 Sheet	Buy now
21	X2Y8A8B110 Sheet 1	Buy now
22	X0P1746300 Nut, lock	Buy now

Steering Handle & Cable

Ref	Part	
1	X2Y859C410 Cap, connector	Buy now



X2YA300-X020

Disclaimer

This document is provided for convenience only. It is **not** an official Yamaha publication and is **not supplied, endorsed, or approved** by Yamaha Motor Co., Ltd.

Reasonable efforts are made to keep information accurate; however diagrams, part references, supersessions, descriptions, and applicability may contain errors or omissions. Specifications and part availability may change without notice.

You are responsible for confirming the correct parts for your engine (including model code, year, serial range, and any superseded part numbers) before ordering or fitting.